

W = 48, L = 250
W = 75, L = 250 and 300

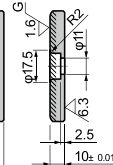
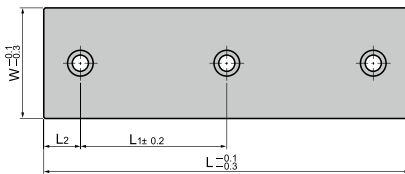

Notes

材质 Material

烧结层 铁镍合金, 1.2mm以上
Copper powder sintered(SO#220)
Hatched Area Sintered Thickness
1.2 mm or more 45C(base plate)

不含螺丝

Screws not included.

运动方向

Sliding Direction



Edge chamfer specification

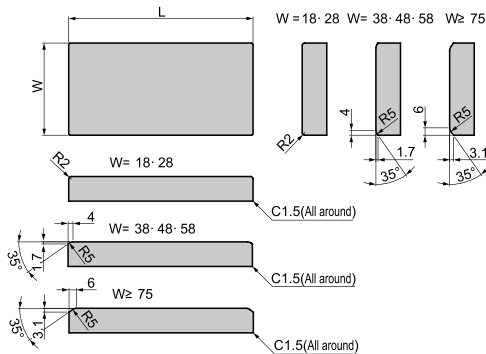

Order Code	W	L	W ₁	W ₂	L ₁	L ₂	
DTOX.02	18	75			45	15	
		100			50	25	
		125			75		
		150			100		
	28	75			45	15	
		100			50	25	
		125			75		
		150			100		
	38	75			45	15	
		100			50	25	
		125			75		
		150			100		
	48	75			45	15	
		100			50	25	
		125			75		
		150			100		
		200			100	50	
		250			100	25	
		58			75	45	15
					100	50	25
	150				100		
	75	75			25	50	
		100			50		
		125			75		
		150			100		
		200			150		
		250			100		
		300			100		50
		100			100		50
	125				75		
	150				100		
	200				150		
	250				200	50	
	125	125			75	37.5	
		150			100		
		200			150		
		250			200		50
	150	150			100	25	
		200			150		
		250			200		

订货
 Order

生产
 Produce

货运
 Transport

Order Code

DTOX.02 - W - L